

1  
2  
3  
4  
5  
6  
7  
8  
9  
10  
11  
12  
13  
14  
15  
16  
17  
18  
19  
20  
21  
22  
23  
24  
25  
26  
27  
28  
29  
30  
31  
32  
33  
34  
35  
36  
37  
38  
39  
40  
41  
42  
43  
44  
45

**CITY OF LABELLE**  
**ORDINANCE 2021-04**  
**1240 W. COWBOY WAY**  
**VOLUNTARY ANNEXATION**

AN ORDINANCE OF THE CITY OF LABELLE, ANNEXING A 0.9+/-ACRE PROPERTY LOCATED IMMEDIATELY NORTH OF COWBOY WAY, APPROXIMATELY ¼ MILE EAST OF STATE ROAD 80 INTO THE CORPORATE LIMITS OF THE CITY OF LABELLE, FLORIDA, IN ACCORDANCE WITH THE ANNEXATION PROVISIONS OF CHAPTER 171, PART II, FLORIDA STATUTES; REDEFINING THE BOUNDARY LINES OF SAID CITY IN CONFORMANCE THEREWITH; AMENDING THE OFFICIAL BOUNDARY MAP OF THE CITY OF LABELLE, FLORIDA, PROVIDING THAT EXISTING FUTURE LAND USE AND ZONING DESIGNATIONS REMAIN UNTIL CHANGED BY THE CITY ORDINANCE; PROVIDING FOR SEVERABILITY; PROVIDING AN EFFECTIVE DATE.

WHEREAS, Halo Real Estate Holdings, LLC has initiated a voluntary annexation of real property, located north of Cowboy Way and ¼ mile east of State Road 80, Hendry County, Florida “the property” as described and depicted in Exhibit “A” and Exhibit “B”, attached hereto; and,

WHEREAS, the City and the County have identified certain lands that are logical for annexation into the City, the appropriate land uses and infrastructure needs for said area, and the provider of services and infrastructure for said areas; and,

WHEREAS, the properties to be annexed shall retain the comprehensive plan future land use and zoning classifications existing at the time this ordinance is approved; unless otherwise requested by the property owner, the properties will become subject to the City Comprehensive Plan Future Land Use and zoning classifications most consistent with the retained classifications upon subsequent action by the City.

NOW, THEREFORE, BE IT ORDAINED by the City Commission of the City of LaBelle, Florida:

**Section 1.** The forgoing recitals are true and correct and are incorporated herein by this reference.

**Section 2.** The City Commission, after duly advertised public hearings on June 10, 2021, and July 8, 2021 Ordinance 2021-08 is hereby adopted, annexing the property in the City of LaBelle municipal boundary.

**Section 3. Conflict with other Ordinances.** The provisions of this article shall supersede any provisions of existing ordinances in conflict herewith to the extent of said conflict.

**Section 4. Severability.** In the event that any portion of this ordinance is for any reason held invalid or unconstitutional by any court of competent jurisdiction, such portion shall be deemed a

46 separate, distinct and independent provision, and such holding shall not affect the validity of the  
47 remaining portions of this ordinance.  
48

49 **Section 5. Effective Date.** This Ordinance shall become effective in accordance with Florida  
50 Statutes.  
51

52  
53  
54 **PASSED AND ADOPTED** in open session this 8<sup>th</sup> day July, 2021.  
55  
56

57 THE CITY OF LABELLE, FLORIDA

58  
59  
60 By:   
61 David A Lyons, Mayor

62 Attest:

63  
64   
65  
66 Thomas A. Smith, Clerk-Commissioner

67  
68 APPROVED AS TO FORM AND  
69 LEGAL SUFFICIENCY:

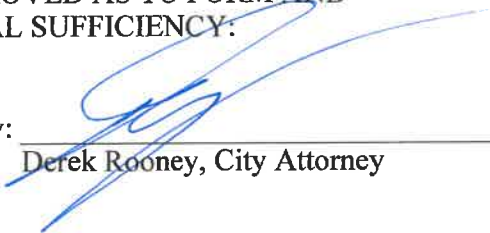
70  
71  
72 By:   
73 Derek Rooney, City Attorney  
74  
75

76	Vote:	AYE	NAY
77			
78	Mayor Lyons	<u>✓</u>	_____
79	Commissioner Smith	<u>✓</u>	_____
80	Commissioner Wilkins	<u>✓</u>	_____
81	Commissioner Akin	<u>✓</u>	_____
82	Commissioner Spratt	<u>✓</u>	_____

83  
84

85 EXHIBIT A

86  
87 LEGAL DESCRIPTION

88  
89 THE NORTH 200 FEET OF THE SOUTH 218 FEET OF THE EAST 200 FEET OF LOT  
90 19, OF WEST LABELLE, L.V. HULL'S SUBDIVISION, ACCORDING TO THE PLAT  
91 THEREOF, AS RECORDED IN PLAT BOOK 3, PAGE 12 OF THE PUBLIC RECORDS  
92 OF LEE COUNTY, FLORIDA NOW SITUATED, LYING AND BEING IN HENDRY  
93 COUNTY, FLORIDA; LESS AND EXCEPT THE SOUTH 7.00 FEET THEREOF FOR  
94 ROAD RIGHT-OF-WAY BY ORDER OF TAKING RECORDED OCTOBER 18, 1994 IN  
95 OFFICIAL RECORDS BOOK 515, PAGE 1065.

96  
97  
98

99  
100

**EXHIBIT B**  
**LOCATION MAP/CURRENT MUNICIPAL BOUNDARY MAP**

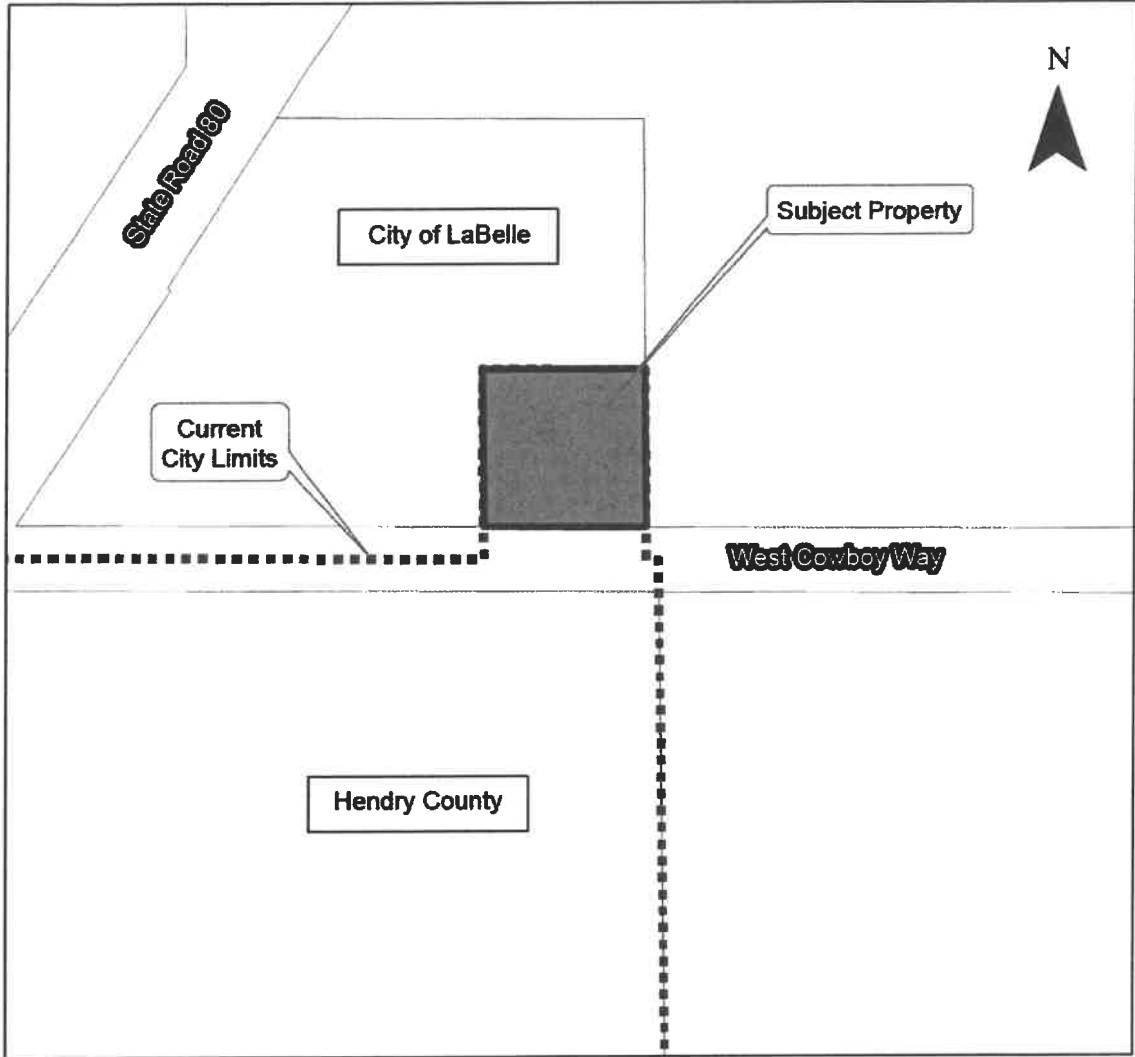

101  
102  
103

104  
105

**EXHIBIT C  
PROPOSED MUNICIPAL BOUNDARY MAP**

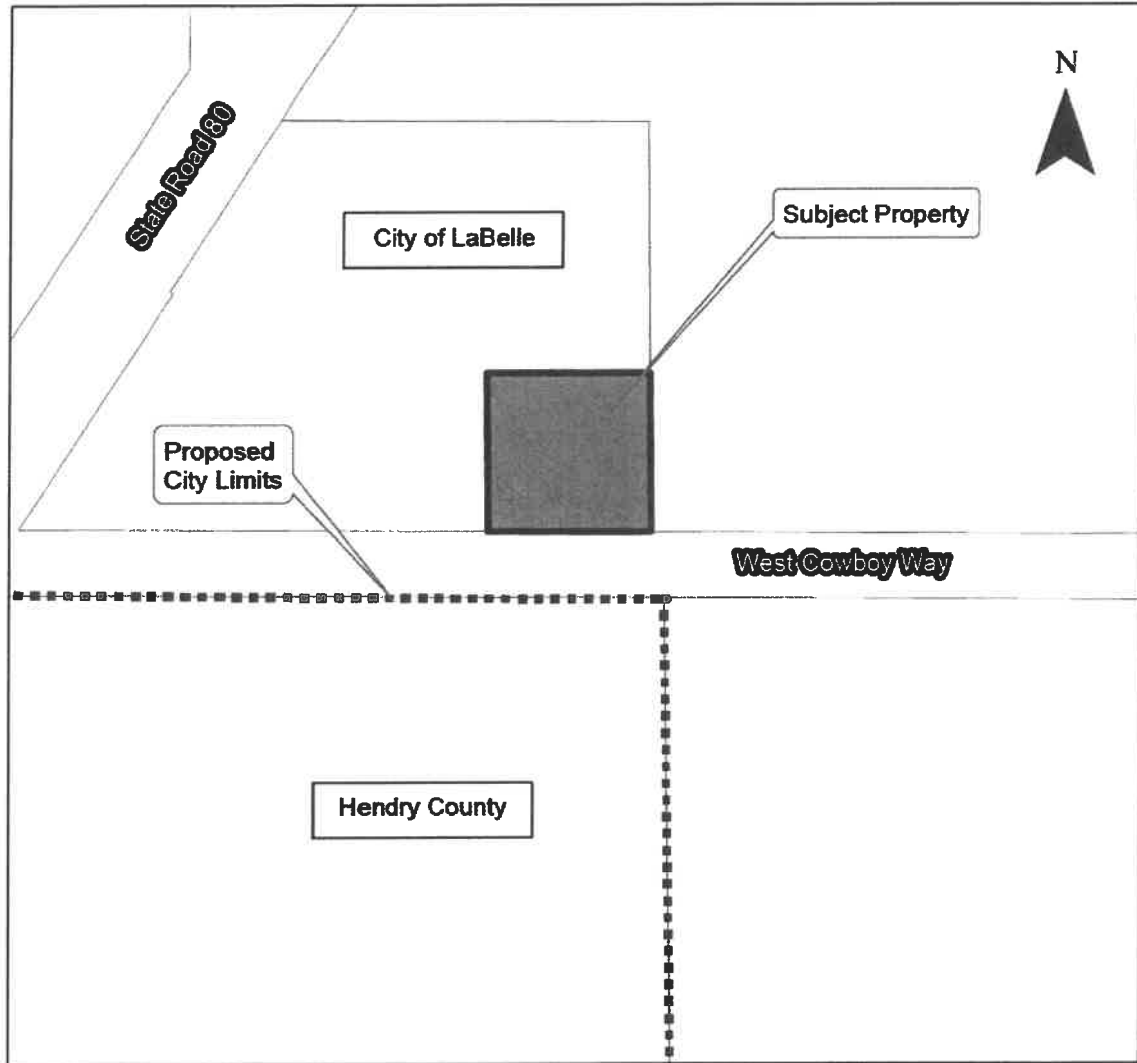

106  
107  
108  
109